

Apartment

# HARDMAN ROAD, KINGSTON UPON THAMES KT2 6ST

Per Calendar Month

# £1,680 Per

FEATURES



# 1 Bedroom Apartment located in Kingston Upon Thames

Central Kingston! Ultra convenient for town centre, train station and shopping.

This larger than average ONE DOUBLE bedroom apartment has been tastefully decorated throughout with a modern bathroom and separate fitted kitchen.

Spacious lounge/diner and one double bedroom with fitted wardrobes.

Benefits include one allocated parking space. Do not miss out!

Council tax band C  
 Deposit - security deposit  
 Holding fee - 1 1 weeks rent.

Call us on  
 020 8546 7771

info@saxonkings.co.uk  
 www.saxonkings.co.uk

Council Tax Band  
**C**

Approximate Area = 490 sq ft / 45.5 sq m  
 For identification only - Not to scale

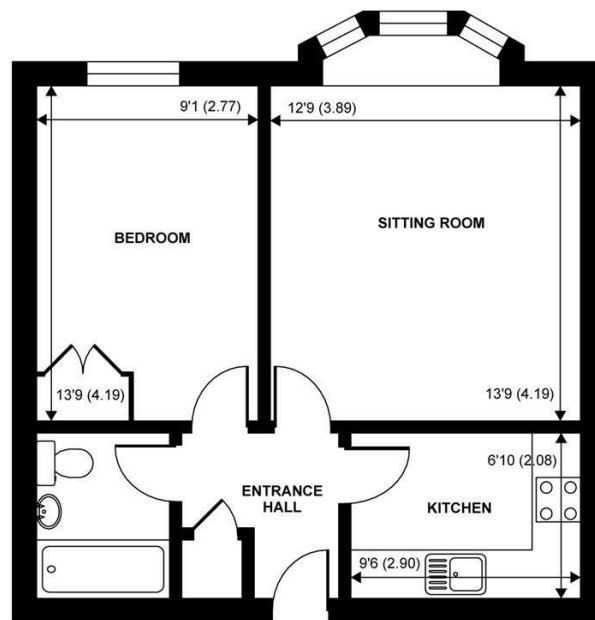

SECOND FLOOR

Energy Efficiency Rating		Current	Potential
<i>Very energy efficient - lower running costs</i>			
(92 plus) <b>A</b>			
(81-91) <b>B</b>			
(69-80) <b>C</b>		75	78
(55-68) <b>D</b>			
(39-54) <b>E</b>			
(21-38) <b>F</b>			
(1-20) <b>G</b>			
<i>Not energy efficient - higher running costs</i>			
<b>England &amp; Wales</b>		EU Directive 2002/91/EC	

Agents Note: Whilst every care has been taken to prepare these particulars, they are for guidance purposes only. All measurements are approximate and are for general guidance purposes only and whilst every care has been taken to ensure their accuracy, they should not be relied upon and potential buyers are advised to recheck the measurements.



Floor plan produced in accordance with RICS Property Measurement Standards incorporating International Property Measurement Standards (IPMS2 Residential). ©nichecom 2021. Produced for Simpsons Estate Agents la Curchods. REF: 701886

